

FOR SALE/BUILD TO SUIT

BOBCAT VILLAGE

Toledo Blade Boulevard and Lexi Lane North Port, Florida 34288

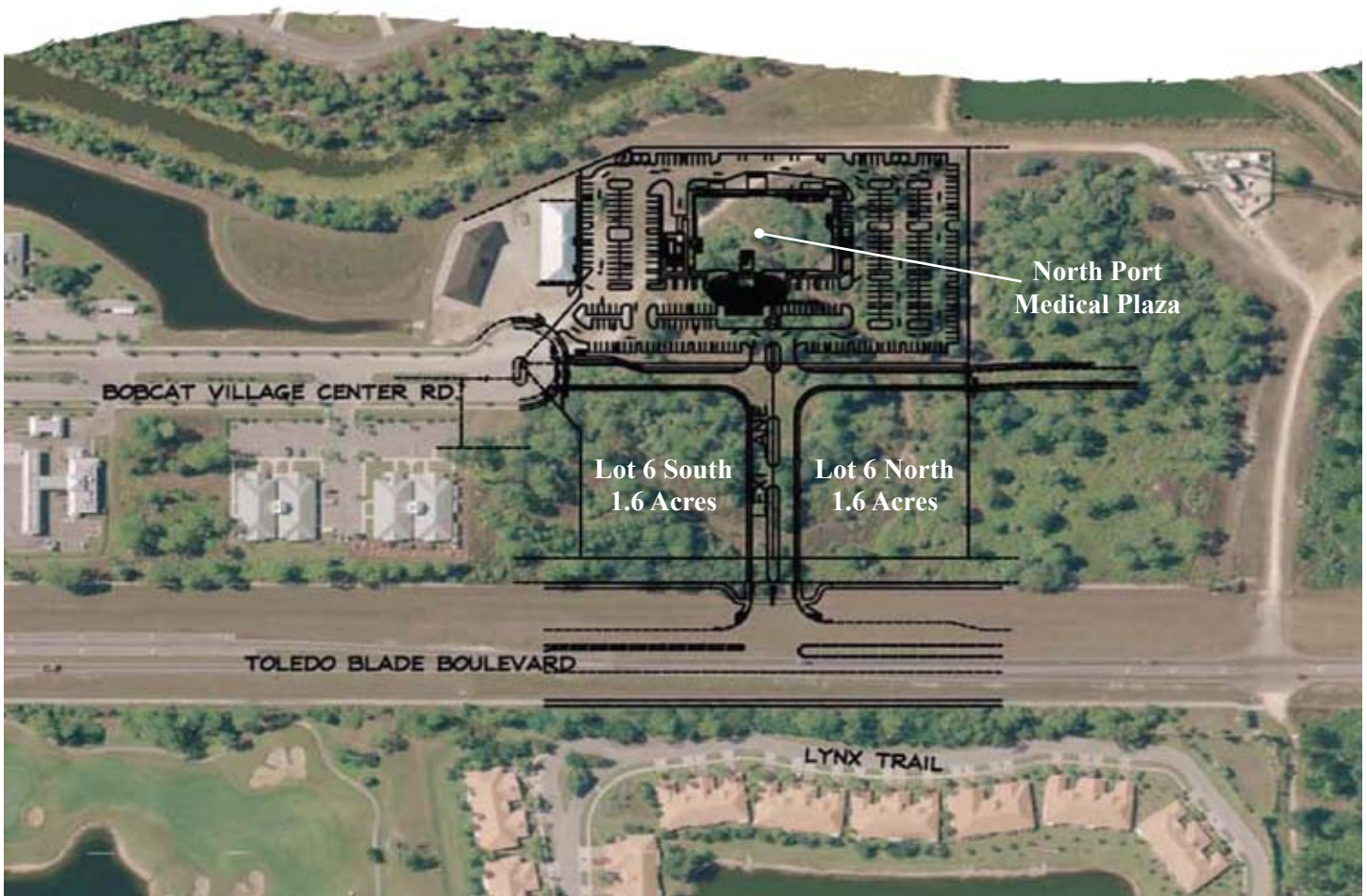

- ★ Two 1.6-acre parcels located in front of newly developed North Port Medical Plaza and Sarasota Memorial Hospital's free-standing emergency room
- ★ Excellent visibility on Toledo Blade Boulevard
- ★ Central location on Toledo Blade Boulevard just south of Price Boulevard with easy access to I-75 and US 41
- ★ Owner is one of the area's premier commercial developers and will consider various options including partnership, build to suit, or land lease



(941) 378-1740

www.starling-group.com

5969 CattleRidge Boulevard, Suite 200
Sarasota, FL 34232